



# WWCI Series

## SMD Wire Wound Ceramic Inductor

### Size 0402

#### CHARACTERISTICS

- ± 0.5% tolerance
- U
- 0
- j

#### APPLICATION

- 

Dimensions: [mm]

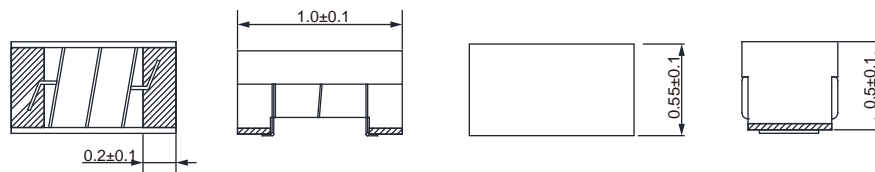

Land Pattern: [mm]

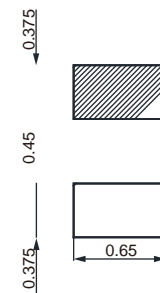

Electrical Properties:

		Condition	D	( )
± ± # @	V "			26
± ± # @	V "			29
± ± # @	V "			
± ± # @	V "			32
± ± # @	V "			35
± ± # @	V "			
± ± # @	V K			
± ± # @	V K			43
± ± # @	V K			45
± ± # @	V K			45
± ± # @	V K		23	49
± ± # @	V K		23	46
± ± # @	V K		23	49
± ± # @	V K			
± ± # @	V K		25	
± ± # @	V K		25	49
± ± # @	V K			





		Condition		D	( )
† † # @	VK	56	±5%		42
† † # @	VK		±5%		36
† † # @	VK		±5%		34
† † # @	VK		±5%		33
† † # @	VK		±5%		
† † # @	k K		±5%		
† † # @	k K		±5%		29

$\frac{1}{u} \dots \dots \dots \# \dots \dots \dots ) \# \dots \dots \dots u \text{ } ^\circ \text{C}$

### Typical Electrical Characteristics:

Inductance VS. Frequency Characteristics:

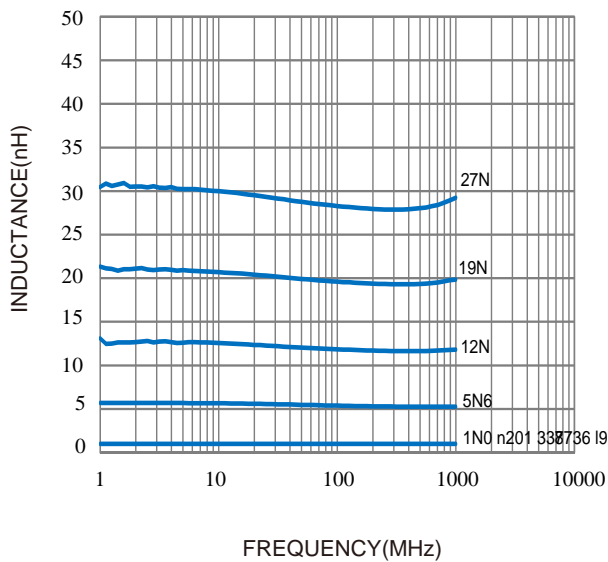

Temperature Rise VS. Frequency Characteristics:

